

HOVERAir X1

—Smart—

Get started

入門指南

入門ガイド

입문 가이드

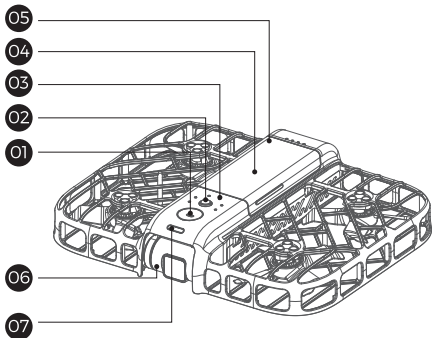

- 01 Power button/take-off button 電源鍵/起飛鍵
電源ボタン/離陸ボタン 배터리 잔량 표시등
- 02 Mode toggle button 模式鍵
モード切り替えボタン 배터리
- 03 Mode indicator 模式指示燈
モードインジケータライト 모드 표시등
- 04 Battery 電池
バッテリー 모드 전환 버튼
- 05 Battery level indicator 電量指示燈
バッテリー残量ライト 전원 버튼/이륙 버튼
- 06 Gimbal 雲台
ジンバル&카메라 상태 표시등
- 07 Status indicator 狀態指示燈
モードインジケータライト 균형 링과 카메라

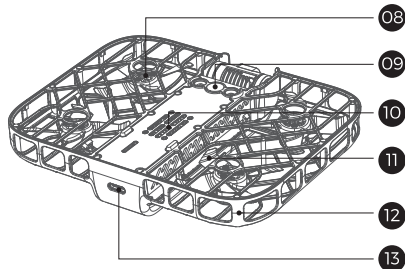

- 08 Motor 馬達
모터 모터
- 09 Bottom visual sensor 底部視覺傳感器
下方비전센서 낮은 시각 센서
- 10 Heat vents 散熱口
放熱エリア 방열 영역
- 11 Propellers 螺旋槳
프로펠라 프로펠러
- 12 Prop guards 保護框
프레임 프레임
- 13 USB-C port USB-C鏈接口
USB-C포트 USB-C 포트

Step 1 Download the App

- Scan the QR Code and download the Hover X1 App.



Step 2 Charging

- Charge the battery

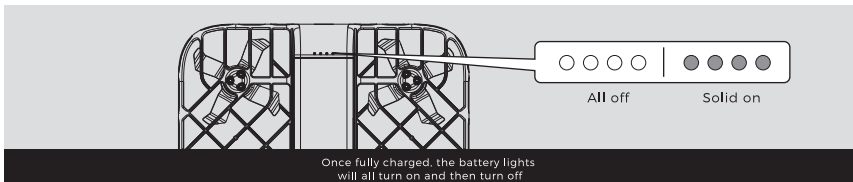
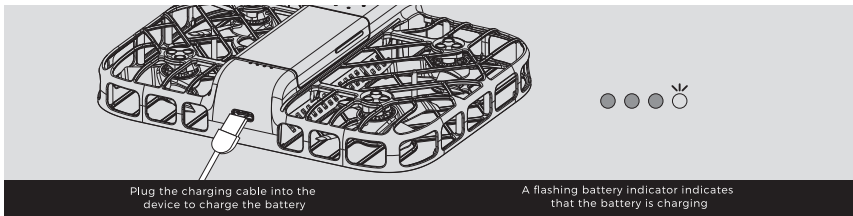

Step 3 Power on/off

- Press and hold the power button until you hear the power on sound and the status light turns green.

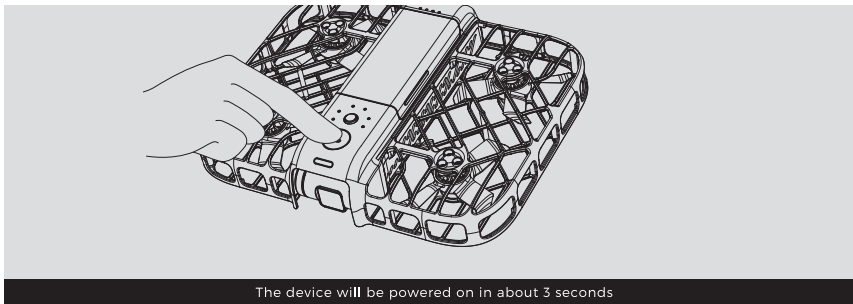

Step 4 Toggle between different flight modes

- Place the HOVERAir X1 Smart flat in the palm of your hand, as shown in the figure below, press the [Mode button] to toggle flight modes, and press the power button again to take off.

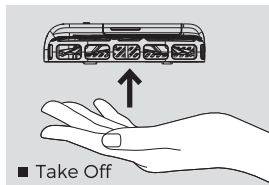
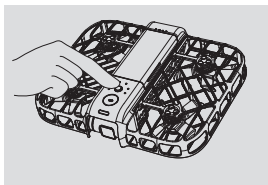
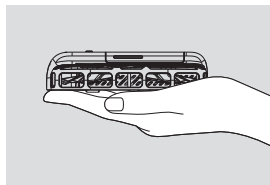

Step 5

Landing your HOVERAir X1 Smart

- Grab the HOVERAir X1 Smart from the air, short press the power button or flip the device 180 degrees, and the propellers will stop turning.

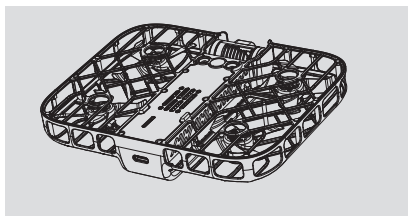
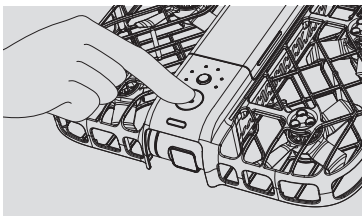

The propellers stop rotating

- Place your palm 20 centimeters below the HOVERAir X1 Smart. HOVERAir X1 Smart will automatically land in the palm of your hand, and the propellers will stop rotating.

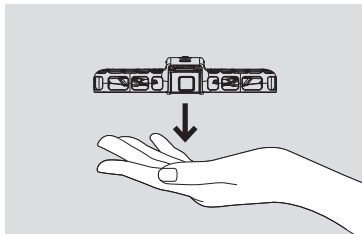

- **Attention:**
Do not insert fingers or other objects into the prop guard.

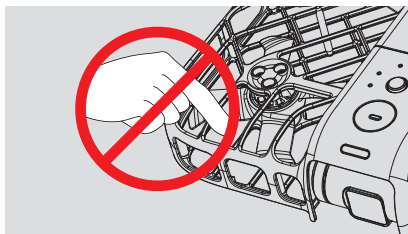

Step 6 Connect to the app

- Use the Hover X1 app to enjoy the best flying experience.

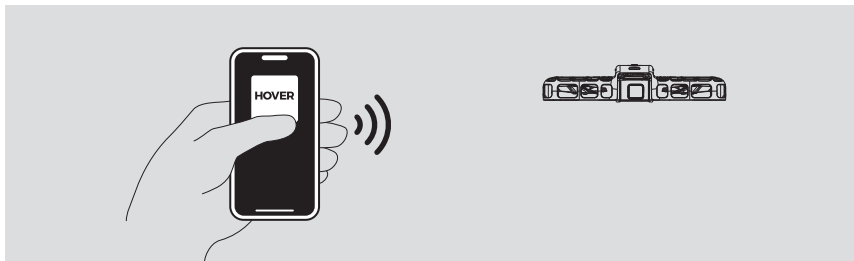

Specifications:

Main specs:

Maximum take-off weight: 99g
Dimensions (LxWxH): 114 x 142 x 27mm
Maximum ascent speed: 1.5m/s
Maximum landing speed: 1.5m/s
Maximum horizontal flight speed (windless): 8m/s
Maximum flight altitude (above sea level):
2,000m, altitude limit 5,000m (not recommended)
Maximum flight time:
10 minutes (measured at 7km/h in windless environment)
Longest hovering time: 9.5 minutes
Maximum Wind Resistance: 7.9m/s (Scale 4)

Camera:

Maximum image size:
4,000 x 3,000 (1,200,000 pixels)
HDR: 2,592 x 1,940 (500,000 pixels)

Image resolution:

2,704 x 1,520@30fps、1,920 x 1,080@60fps、
1,920 x 1,080@30fps (HDR)

Ambient temperature: 0°C ~ 40°C
Support USB interface: USB-C
Useful Wi-Fi: 2.4GHz frequency、5.8GHz frequency
Storage space: 32GB
Battery capacity: 690mAh, 5.313Wh
Battery type: Lithium battery
Charging environment temperature: 5°C ~ 40°C
Maximum charging power: 12.144W
Rated voltage: 7.7V
Diagonal distance: 10.2 cm
Propeller radius: 2.5 cm

App:

Hover X1
OS Requirements:
iOS 12.1 and above, Android 9.0 and above

Disclaimer and Safety Manual

Disclaimers and Warnings

This manual contains important information for the safe and correct usage of this product. Please read this handbook carefully before using the product. The HOVERAIR XI Smart is a small flying camera for taking pictures and videos. This product is not a toy and should not be operated by a person whose use of the product would create safety concerns, including but not limited to:

1. Children under the age of 14; Minors between the ages of 15 and 18 should be accompanied by a parent or guardian or must be supervised by a professional.
2. Persons affected by alcohol, illegal drugs, drugs, dizziness, tiredness, or other unpleasant physical or mental conditions.
3. Please avoid obstacles, people, animals, buildings, public facilities, trees and water during flight. Please pay special attention when the altitude of the device rises.
4. Before operating the HOVERAIR XI Smart, please read the entire handbook to understand the product features. Improper use of the product may cause property damage, accident or injury to personnel. By using this product, you signify that you understand, accept and agree to all the terms and conditions of this document.
5. The user agrees to be responsible for his own actions and all derived results. The user agrees that this product should only be used for safe and lawful purposes and agrees to all terms and contents of this document.
6. Unless otherwise specified, any advice or information obtained from relevant policies or treaty guidelines, products, product accessories or other aspects does not apply to any of the company or its products.

Guidelines for safe use

● Flying environment

This product must be flown in an area where general flight is permitted. Flight area restrictions include, but are not limited to:

1. This product uses a bottom-facing visual sensor. Please observe the following rules.
 - This product is only suitable for heights between 0.5 and 15 meters.
 - Avoid flying at night. Vision systems may not be able to recognize low-light ground features at night.
 - Please note that if the ground texture is not clear, the vision system may malfunction. Use your device with caution in any of the following situations: monochrome ground, water or transparent ground, highly reflective ground, areas with frequent light changes, very dark or very bright ground, and areas with moving objects at the bottom.
 - The bottom facing visual sensor should be kept clean at all times. Do not occlude or block the visual lens
2. Do not operate the product in areas with large elevation differences between the surface (e.g., flying out of windows of tall buildings, etc.)
2. Do not use the device in inclement weather. Extreme weather conditions include high winds (winds over level 4), snow, rain, dense fog, strong winds, hail, lightning, tornadoes, and typhoons.
3. Do not operate the product in weather conditions below 0°C or above 40°C.
4. Do not operate the product in no-fly areas. For more information on no-fly zones, please refer to the Local Laws and Flight Regulations for Flying section.
5. Avoid flying at an altitude of more than 2,000m.
6. When taking off in deserts, beaches, or other areas where there are many solid particles, operate the flight camera carefully to avoid solid particles from entering the body or parts of the flight camera.

● Use of wireless communication (Wi-Fi)

When using the wireless remote control function, this product should be flown in a situation where the wireless communication is working properly. Please note the following:

1. This product should be flown in an open area free of obstacles.
2. Do not fly around areas with magnetic or radio interference. These areas include, but are not limited to, Wi-Fi hotspots, Bluetooth devices, high voltage cables, high voltage substations, radar stations, mobile base stations, and broadcast towers. If used in areas with a high degree of interference, the product may malfunction. If used in areas with high levels of interference, the product may become abnormal or uncontrollable. These abnormal behaviors may result in degraded product quality and image transmission errors.

● Pre-flight confirmation

Before using this product, be sure to understand all features, flight requirements, and relevant government issued regulations, including but not limited to:

1. Make sure the product is fully charged before flying.
2. Before using the product, check that the device and its components, including but not limited to the prop guards, motor, batteries, propellers, gimbal and other flight related components are functioning properly.
3. The Hover X1 App is updated to the latest version.
4. Read and understand the product information, including the disclaimer and the Safety Manual and Getting Started Guide, to familiarize yourself with the product, its operation and features.

● How to safely operate

Always pay attention to safety regulations to ensure proper operation of the HOVERAIR X1 Smart. The user shall be responsible for personal or property injury caused by improper usage of the HOVERAIR X1 Smart. Proper operating procedures include, but are not limited to:

1. Stay away from rotating propellers and motors.
2. Confirm an appropriate flying environment of the HOVERAIR X1 Smart. To ensure the proper functioning of the bottom facing visual system, avoid flying on the water or snow. For more information, please refer to the "Flight Environment" section.
3. Ensure that the product is used in an environment where there are no obstructions. Please pay attention to your surroundings during the flight to prevent accidents.
4. Please ensure there is sufficient battery to operate and fly normally. If the device powers off due to low battery or other errors, the video or image recording may be damaged or not saved. The Company shall not be liable for any damage or loss of data caused by any user error.
5. Do not tamper with the gimbal
6. The Company shall not be liable for any malfunction, injury or accident caused by the use of accessories other than the Qualified Products.
7. Do not modify or disassemble the product. The user shall be responsible for the consequences of any modification or disassembly.

● Other precautions

1. Do not use the product while under the influence of alcohol, illegal drugs, medication, anesthesia, or other conditions that may cause physical or cognitive impairment (e.g., dizziness, fatigue, or nausea).
2. Do not drop or throw the product or load the product with hazardous materials. Do not use it around buildings, people, or animals. Doing so may result in injury or property damage.
3. Do not use any product that has experienced been damaged or has performed abnormally during flight.
4. Please respect the privacy of others when using the product. Do not take any images or record videos without consent. In the case of privacy, this should also be taken into account when individuals use the product to take images or videos.
5. Comply with local rules and regulations regarding drone flights. Do not use the drone for illegal or improper activities, including but not limited to espionage, military operations and other illegal or improper purposes.
6. To ensure safety, do not insert fingers or foreign objects into the protective frame. The user shall be responsible for any damage or injury caused by inserting fingers or foreign objects into the protective frame.

Product Maintenance

● Maintenance and Storage

1. Place the HOVERAIR X1 Smart in a protective case. Do not expose the product to shocks or severe electric shock, or prolonged exposure to sunlight. Store in a cool, dry place protected from direct sunlight.
2. Do not allow the HOVERAIR X1 Smart to come into contact with or be immersed in rain or other liquids. If your HOVERAIR X1 Smart comes into contact with water, dry it with a soft, absorbent cloth. Opening a HOVERAIR X1 Smart that has been dropped in water may cause irreparable damage to parts. Do not use alcohol, benzene, diluted liquids or other flammable substances to clean or store this product. Do not store the product in wet or dirty places.
3. Store the battery in a suitable place when the flight camera is not in use.
Recommended battery storage temperature:
Short-term storage (within 3 months): -10°C - 30°C
Long-term storage (3 months or more): 25±3°C
4. Please pay attention to any battery abnormalities. If any battery abnormalities occur, replace them with new ones immediately. Please refer to the "Battery Safety Guide" for battery maintenance and storage guidelines.

● Precautions for transportation

1. Suitable temperature for transporting the battery: 23±5°C
 2. Please refer to your local airport regulations before taking your batteries on board and do not transport damaged or faulty batteries.
- For more information on batteries, please refer to the Battery Safety Guide.

● Local laws and flight regulations related to flying

Local laws and policies related to flight restrictions vary by country and region. For more information, please contact your local authority.

● Legal flight restrictions

1. The HOVERAir X1 Smart should not be flown in and around no-fly zones designated by local laws and regulations.
2. Do not fly in areas where crowds of people gather, such as public performances and events.
3. The HOVERAir X1 Smart should fly within the operator's line of sight.
4. Do not use HOVERAir X1 Smart to transport illegal or dangerous goods or cargo.
5. Before flying, understand the type of flight activity, check and comply with all local regulations and practices, as actual regulations may differ from those described in this document.

Do not participate in unauthorized or unpermitted flights, flights that violate the legal rights of others (e.g., rights of privacy and publicity), or illegal flights.

● Flight Restrictions

1. Users should use the product safely in accordance with local laws and regulations. Users should update the App to the latest version.
2. Restricted areas include, but are not limited to, major airports, major cities/regions, and event venues around the world. Please consult and comply with all local regulations and practices before flying products.
3. When flying, please be aware of your surroundings and avoid obstacles, including but not limited to buildings, roofs, power lines and trees.

Declaration of the Presence Condition of the Restricted Substances Marking

Equipment name:HOVERAir X1Smart		Type designation (Type):ZZ-H-1-002				
Unit	Restricted substances and its chemical symbols					
	Lead (Pb)	Mercury (Hg)	Cadmium (Cd)	Hexavalent chromium (Cr6)	Polybrominated biphenyls(PBB)	Polybrominated diphenyl ethers(PBDE)
Shell	○	○	○	○	○	○
Main board	○	○	○	○	○	○

Note 1: "Exceeding 0.1 wt %" and "exceeding 0.01 wt %" indicate that the percentage content of the restricted substance exceeds the reference percentage value of presence condition.

Note 2: "○" indicates that the percentage content of the restricted substance does not exceed the percentage of reference value of presence.

Note 3: The "-" indicates that the restricted substance corresponds to the exemption.

I hereby ensure that "the presence conditions of the restricted substance" provided above have been proved by testing or appropriate quality control measures, and make sure the relevant documents provided are correct and ready. Also, I agree to cooperate with BSMI, as the Article 49 of the Commodity Inspection Act stipulates, to provide the relevant documents, if needed, for verification within 28 working days when BSMI carries out the market surveillance activities.

This content is subject to change

For the latest version, please contact the official website or the Help Support Center

Shenzhen Zero Zero Unlimited Technology Co., Ltd. All rights reserved